

G OT Clock Assembly instructions

Firstly if you have downloaded this model before the 10th of March 2020 you will need to separate the "Glass Ring" from the Bezel.

This is due to an un-noticed error on my part. I forgot to create separate stl files for these parts. I apologize for any frustration caused.

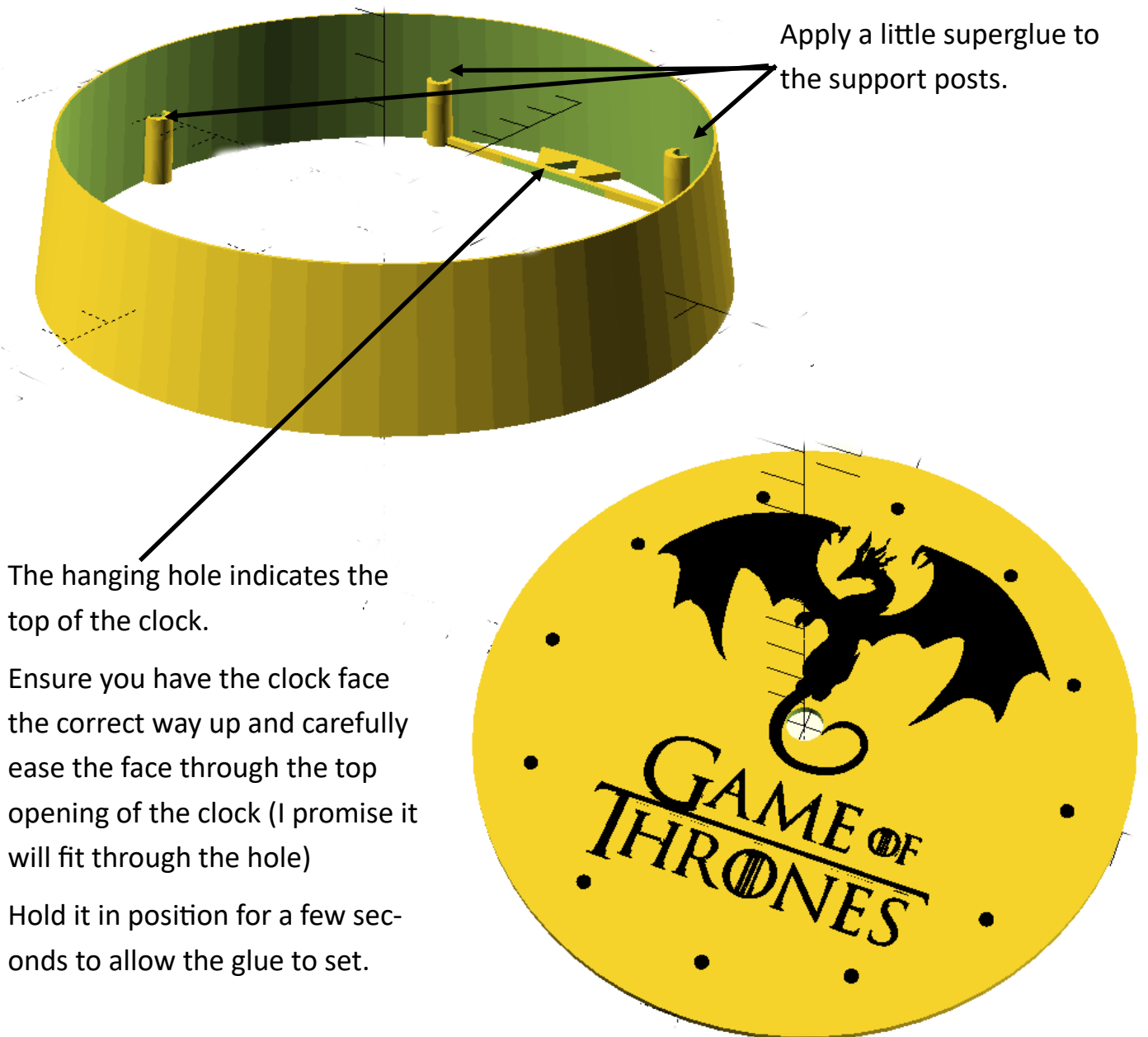

I found a stiff piece of clear plastic around 1 mm thick that I used for my clock glass.

Cut this to fit inside the “Bezel” (the front of the clock). Now take the “Glass Ring” and glue it inside the bezel sandwiching the glass between the bezel and the glass ring.

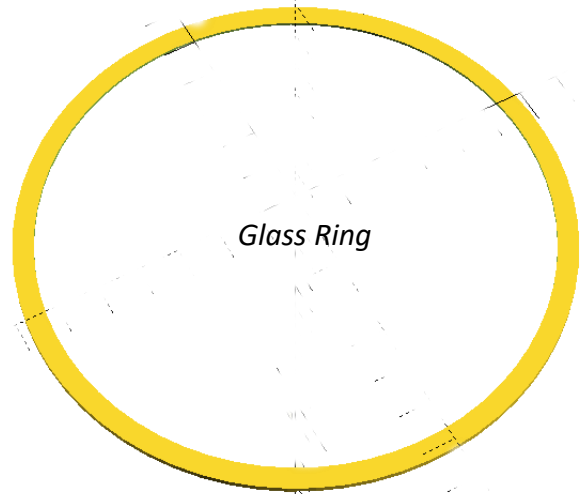
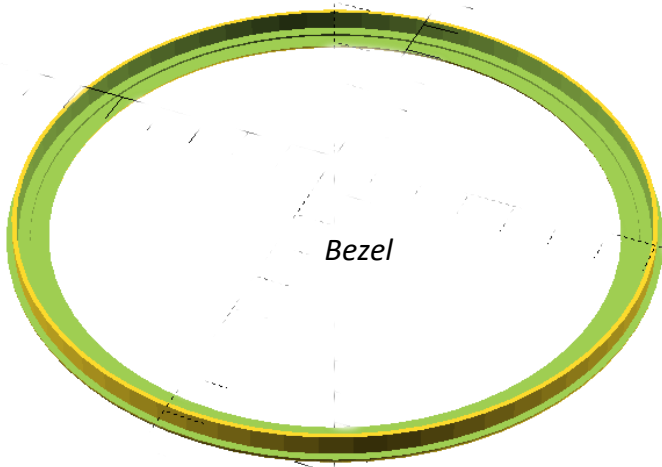

Attach your clock mechanism. I found that the hands tended to touch the glass, so I have provided a spacer disk to go between the mechanism and the back of the “Face”.

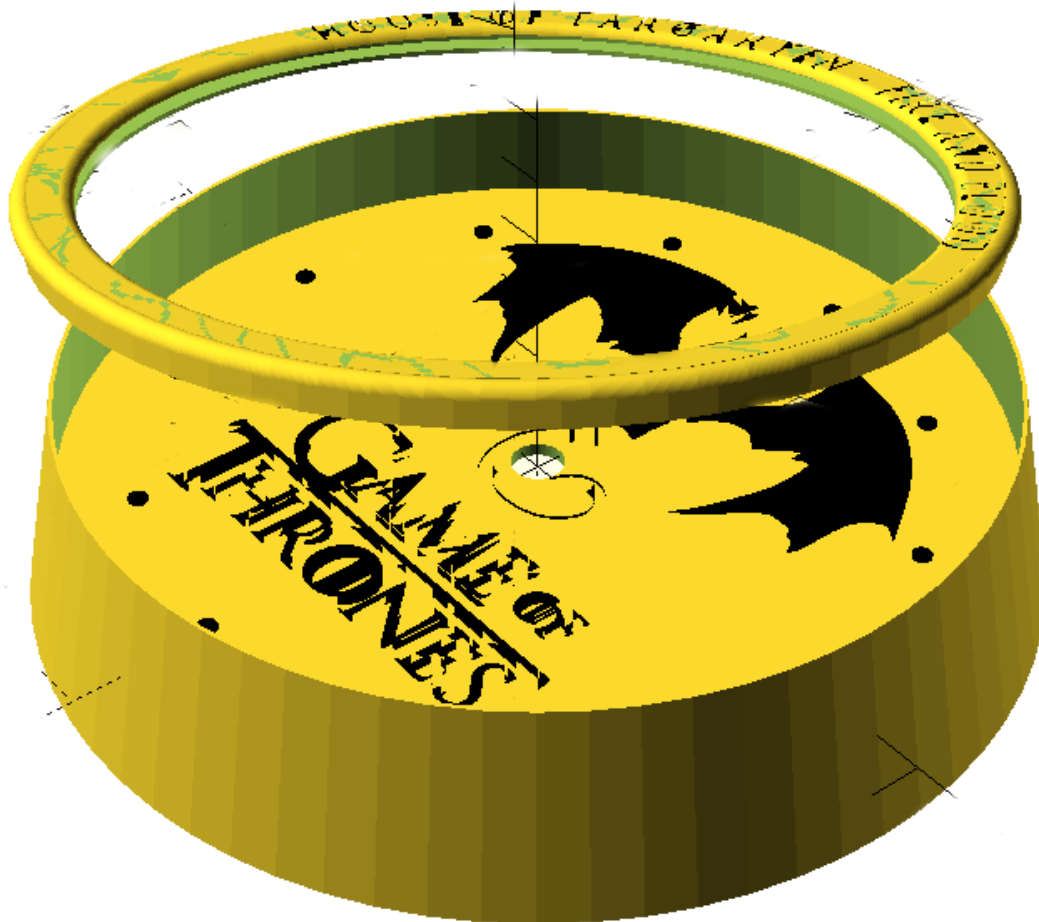
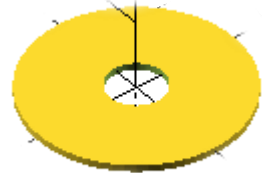

To attach the bezel to the clock, first apply a few spots of glue to the bezel edge (don't glue the entire edge in case you need to remove the bezel in the future) and simply push it into place

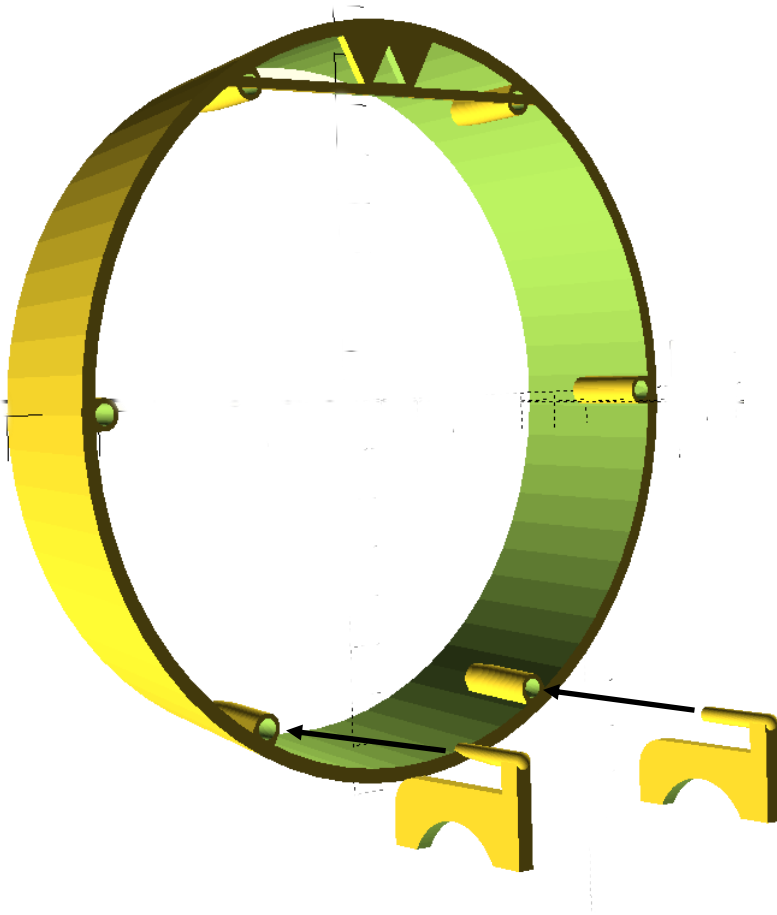

If you want to stand the clock rather than hang it you can use the feet. These simply push into the holes on the back of the supports.